

Plotted By: Abilad, Emmanuel, Sheet: C-200, LAYOUT: C-200 HORIZONTAL CONTROL, SIGNAGE AND MARKING PLAN, September 09, 2025, 05:38:25pm, K:\FTL\_Civil\043 jbb\043175014 Mill Creek Pompano\Design\CADD\PlanSheets\C-HORZ.dwg  
This document, together with the concepts and designs presented herein, as an instrument of service, is intended only for the specific purpose and client for which it was prepared. Reuse of and improper reliance on this document without written authorization and adaptation by Kimley-Horn and Associates, Inc. shall be without liability to Kimley-Horn and Associates, Inc.

NANCY WATERWAY  
70' CANAL RIGHT-OF-WAY

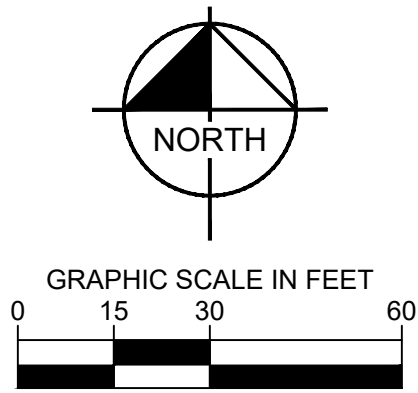
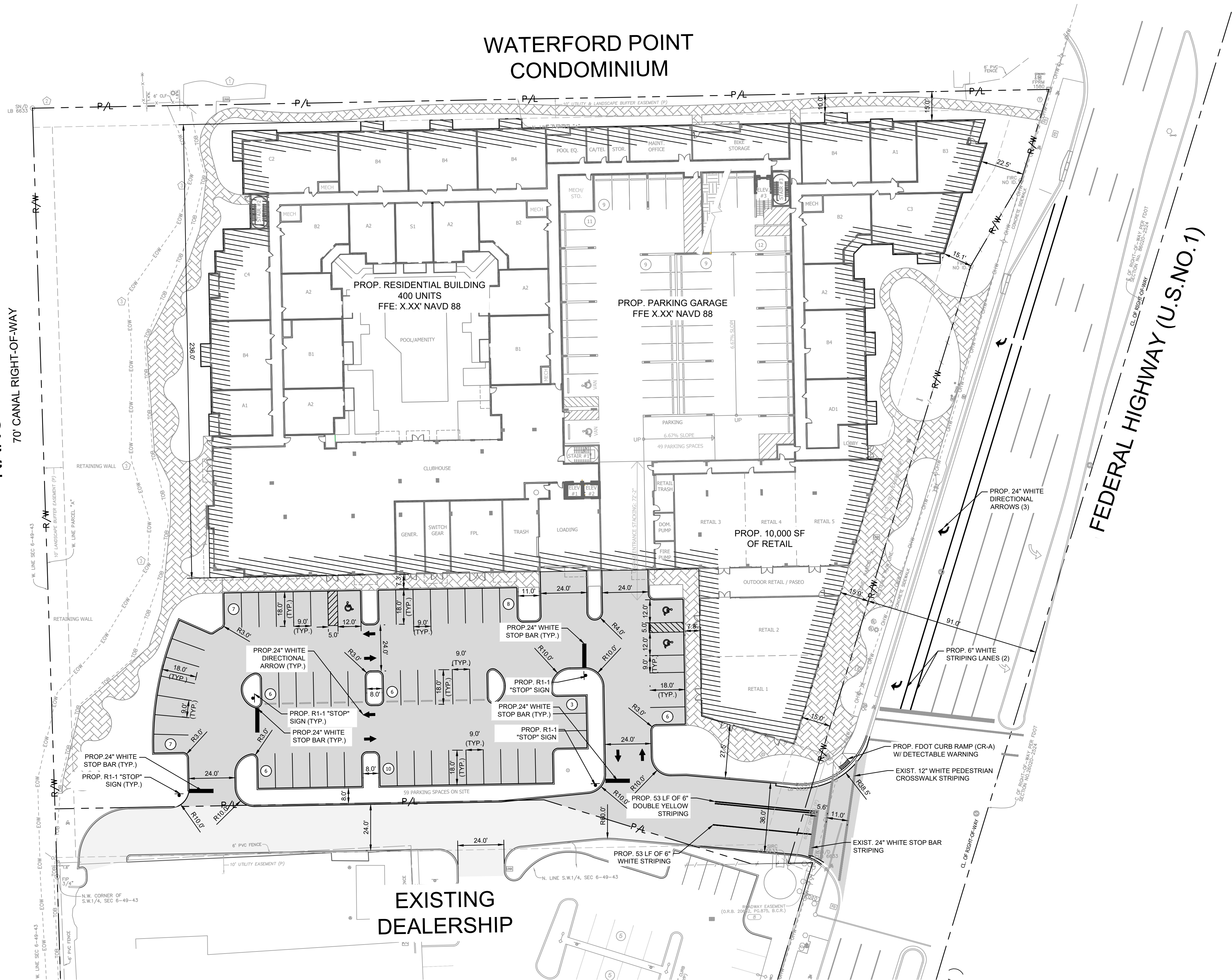

- LEGEND**
- P/L — PROPERTY LINE AND/OR RIGHT-OF-WAY
  - C — CENTERLINE OF R/W
  - (10) — PARKING COUNT

- NOTES**
- SEE PAVEMENT MARKING AND SIGNAGE PLANS DETAILS.
  - CONTRACTOR SHALL REPLACE ALL STRIPING REMOVED AND/OR DAMAGED DURING CONSTRUCTION ALONG THE ROAD ABUTTING THE PROPERTY PER APPLICABLE CITY, COUNTY, AND/OR STATE STANDARDS.
  - CONTRACTOR SHALL FIELD VERIFY THAT ALL EXISTING AND PROPOSED ADA ITEMS WITHIN PROJECT LIMITS (I.E. ROUTES, PARKING, STRIPING, SIGNAGE, ETC.) MEET THE MINIMUM REQUIREMENTS AND SHALL ADJUST ACCORDINGLY, BEFORE THE PROJECT CAN BE DEEMED CERTIFIED AND COMPLETE.
  - ALL CURB RAMPS AND DETECTABLE WARNINGS TO BE INSTALLED IN ACCORDANCE WITH FOOT STANDARD INDEX 522-002 (LATEST EDITION).
  - ALL SIGNS TO BE INSTALLED PER BCTED MOST CURRENT STANDARDS AND FDOT DESIGN STANDARDS INDEX NO. 700 (LATEST EDITION), AND AS SHOWN ON THE PLANS UNLESS OTHERWISE NOTED.
  - ALL PAVEMENT SYMBOLS AND MARKINGS SHALL BE THERMOPLASTIC PAVEMENT MARKINGS UNLESS OTHERWISE NOTED. INSTALLATION AND MATERIALS SHALL MEET ALL REQUIREMENTS OF SECTION 711 OF FDOT STANDARD SPECIFICATIONS FOR ROAD AND BRIDGE CONSTRUCTION AND BCTED MOST CURRENT STANDARDS.
  - ALL PAVEMENT MARKINGS SHALL BE INSTALLED IN ACCORDANCE WITH FDOT STANDARD INDEX NO. 711 (LATEST EDITION) AND BCTED MOST CURRENT STANDARDS.
  - PAINTED PAVEMENT MARKINGS, INSTALLATION AND MATERIALS SHALL MEET ALL REQUIREMENTS OF SECTION 710 OF FDOT STANDARD SPECIFICATIONS FOR ROAD AND BRIDGE CONSTRUCTION, AND THE FOLLOWING:
    - A. APPLY TWO COATS OF VOC COMPLIANT, LOCAL DOT APPROVED, UNDILUTED SOLVENT BASED OR LATEX TRAFFIC PAINT.
    - B. FOLLOW MANUFACTURERS RECOMMENDED APPLICATION RATE, WITHOUT THE ADDITION OF A THINNER, WITH A MAXIMUM OF 100 SF PER GALLON, OR AS REQUIRED, PROVIDING MINIMUM 25 MILS WET FILM THICKNESS AND 7.5 MILES DRY FILM THICKNESS PER COAT WITH MINIMUM OF 30 DAYS BETWEEN APPLICATIONS.
    - C. SECOND COAT OF PAINT SHALL NOT BE APPLIED EARLIER THAN 7 DAYS PRIOR TO GRAND OPENING.
    - D. PAINT SHALL BE CRISP, STRAIGHT, AND APPLIED UNIFORMLY ACROSS THE WIDTH OF THE LINE FOR A TOTAL DRY FILM THICKNESS OF 15 MILS.
  - CONTRACTOR SHALL NOT ALLOW TRAFFIC ONTO NEWLY APPLIED PAVEMENT STRIPING/ MARKINGS UNTIL THEY ARE SUFFICIENTLY DRY TO PERMIT VEHICLES TO CROSS THEM WITHOUT DAMAGE. THE CONTRACTOR SHALL, AT HIS OWN EXPENSE, REMOVE AND REPLACE ANY PORTION OF THE PAVEMENT STRIPING/MARKINGS DAMAGED BY PASSING TRAFFIC OR ANY OTHER CAUSE.
  - SIGNS SHALL BE IN ACCORDANCE WITH SECTION NO. 700, HIGHWAY SIGNING, OF THE FDOT STANDARD SPECIFICATIONS FOR ROAD AND BRIDGE CONSTRUCTION AND BCTED MOST CURRENT STANDARDS.
  - TRAFFIC SIGNS SHALL BE INSTALLED IN ACCORDANCE WITH THE U.S. DEPARTMENT OF TRANSPORTATION MANUAL OF UNIFORM TRAFFIC CONTROL DEVICES (MUTCD), PART II AND BCTED MOST CURRENT STANDARDS, AND IN THE LOCATIONS SHOWN ON PLANS.
  - PARKING STALL MARKINGS DEPICTED ON PLAN ARE FOR GRAPHICAL PURPOSES ONLY.
  - CONTRACTOR TO COORDINATE WITH THE CITY, COUNTY, AND FDOT REGARDING THE CONSTRUCTION AND PHASING OF THE WAVE STREETCAR ROADWAY AND TRAFFIC SIGNAL IMPROVEMENTS.
  - ALL EXISTING SIGNALIZATION EQUIPMENT TO REMAIN IS ASSUMED TO BE IN GOOD WORKING ORDER UNLESS BCTED IS NOTIFIED IN WRITING PRIOR TO START OF CONSTRUCTION, ANY SUBSEQUENT DAMAGE TO THE SIGNAL EQUIPMENT SHALL BE REPAIRED BY THE CONTRACTOR AT THE CONTRACTOR'S EXPENSE.
  - ALL EXISTING MARKINGS WITHIN THE EXTENTS OF MILLING AND RESURFACING AND FULL DEPTH RESTORATION ARE TO BE REMARKED TO MATCH EXISTING CONDITIONS.

- BROWARD COUNTY NOTES:**
- BROWARD COUNTY TRAFFIC ENGINEERING DIVISION'S REVIEW DOES NOT INCLUDE A REVIEW AND ACCEPTANCE OF THE PROJECTS DESIGN OR OPERATION. THESE ITEMS ARE TO BE REVIEWED AND APPROVED BY THE CITY ENGINEER.
  - BROWARD COUNTY TRAFFIC ENGINEERING DIVISION DOES NOT REVIEW AND APPROVE, OR INSPECT AND ACCEPT THE FOLLOWING ITEMS FOR MAINTENANCE: PAVEMENT MARKINGS ON OR ADJACENT TO PAVER BRICKS, PAINTED ASPHALT, STAMPED ASPHALT OR PAVEMENT MARKINGS MADE OF PAVER BRICKS, RAISED INTERSECTIONS AND RELATED MARKINGS AND SIGNING, UN-WARRANTED CROSSWALKS AND RELATED MARKINGS AND SIGNING, UN-WARRANTED CROSSWALKS AND RELATED MARKINGS AND SIGNING, PAINTED DECORATIVE CROSSWALKS, RAISED CROSSWALKS AND RELATED MARKINGS AND SIGNING, ADVANCED WARNING PAVEMENT MARKINGS FOR SPEED TABLES, BLINKER SIGNS, RECTANGULAR RAPID FLASHER BEACONS AND RELATED MARKINGS AND SIGNING, ON-STREET PARKING AND RELATED MARKINGS AND SIGNING, IN-ROAD LIGHTING AND RELATED MARKINGS AND SIGNING, GREEN BIKE LANES, FLEXIBLE DELINEATORS, DECORATIVE SIGNS AND DECORATIVE SIGN POSTS, PLANTERS, ON-SITE PAVEMENT MARKINGS AND SIGNING, OFF-SITE PAVEMENT MARKINGS AND SIGNING IN RIGHT-OF-WAY THAT IS NOT DEDICATED FOR PUBLIC USE, SIDEWALK WORK OR ASPHALT WORK.
  - THE CITY ENGINEER IS RESPONSIBLE FOR THE REVIEW AND APPROVAL OF THE DESIGN AND OPERATION OF THE PROJECT, AND FOR THE INSPECTION AND ACCEPTANCE OF THE FOLLOWING ITEMS THAT WILL BE MAINTAINED BY THE CITY: PAVEMENT MARKINGS ON OR ADJACENT TO PAVER BRICKS, PAINTED ASPHALT, STAMPED ASPHALT OR PAVEMENT MARKINGS MADE OF PAVER BRICKS, PAVEMENT MARKINGS ON OR ADJACENT TO PAINTED ASPHALT, RAISED INTERSECTIONS AND RELATED MARKINGS AND SIGNING, UN-WARRANTED MID-BLOCK CROSSWALKS AND RELATED MARKINGS AND SIGNING, UN-WARRANTED CROSSWALKS AND RELATED MARKINGS AND SIGNING, PAINTED DECORATIVE CROSSWALKS, RAISED CROSSWALK AND RELATED MARKINGS AND SIGNING, ADVANCED WARNING PAVEMENT MARKINGS FOR SPEED TABLES, BLINKER SIGNS, RECTANGULAR RAPID FLASHER BEACONS AND RELATED MARKINGS AND SIGNING, ON-STREET PARKING AND RELATED MARKINGS AND SIGNING, IN-ROAD LIGHTING AND RELATED MARKINGS AND SIGNING, GREEN BIKE LANES, FLEXIBLE DELINEATORS, DECORATIVE SIGNS AND DECORATIVE SIGN POSTS, PLANTERS, ON-SITE PAVEMENT MARKINGS AND SIGNING, OFF-SITE PAVEMENT MARKINGS AND SIGNING IN RIGHT-OF-WAY THAT IS NOT DEDICATED FOR PUBLIC USE, SIDEWALK WORK OR ASPHALT WORK.
  - ALL TRAFFIC SIGNAGE AND PAVEMENT MARKING TO BE PROVIDED ON THIS PROJECT IN CONFORMANCE WITH BROWARD COUNTY TRAFFIC ENGINEERING DIVISION (BCTED) AND MUTCD STANDARDS.

|                      |  |  |  |                                      |  |                   |  |                       |  |                |  |                   |  |                    |  |
|----------------------|--|--|--|--------------------------------------|--|-------------------|--|-----------------------|--|----------------|--|-------------------|--|--------------------|--|
| KIMLEY-HORN          |  | KHA PROJECT<br>043175014                     |  | DATE<br>9/4/2025                     |  | SCALE<br>AS SHOWN |  | DESIGNED BY<br>GVF    |  | DRAWN BY<br>EA |  | CHECKED BY<br>GVF |  | DATE<br>10/15/2025 |  |
| MODERA POMPANO BEACH |  | HORIZONTAL CONTROL, SIGNAGE AND MARKING PLAN |  | PREPARED FOR<br>MCRT INVESTMENTS LLC |  | FLORIDA           |  | SHEET NUMBER<br>C-200 |  | POMPA          |  | REVISIONS         |  | BY                 |  |

PZ25-12000028

10/15/2025